

100 Series Diesel Fuel Filter/Water Separators



MODEL 100
Diesel Fuel Filter/Water Separator



MODEL 100-M
Marine Diesel Fuel Filter/Water Separator



MODEL 100-MFV
Double Manifold Diesel Fuel Filter/Water Separator
with Shut-Off Valves for Continuous Operation



MODEL 100-MMV
Double Marine Manifold Diesel Fuel Filter/Water Separator
with Shut-Off Valves for Continuous Operation

Specifications

- **Flow Resistance:**0.75 In. Mercury
- **Maximum Working Pressure:**.....25 PSI (172 kPa)
- **Temperature Range:**-50° to +225°F (-45° to +107°C)
- **Port Thread:**
Single Units:9/16-18 w/O-Ring Boss
Double Units:1/4-18 NPT
- **Height:**12 1/2 In. (317.5 mm)
- **Width:**5 1/2 In. (139.7 mm)
- **Depth:**6 1/2 In. (165.1 mm)
- **Element Removal Clearance:**.....1 1/2 In. (38.1 mm)
- **Sump Capacity:**8 oz. (236 ml)

Flow Rates

- **Single Model 100 Series:**
Recommended:.....40 GPH (U.S.) (151 LPH)
Maximum:65 GPH (U.S.) (246 LPH)
- **Double Model 100 Series:**
Recommended:.....80 GPH (U.S.) (302 LPH)
Maximum:130 GPH (U.S.) (492 LPH)

Service Parts

- **Elements:**
101*4 Micron Nominal (20 Absolute) Element
101-W.....5 Micron Nominal (25 Absolute) Element
101-309 Micron Nominal (40 Absolute) Element
- **Gaskets:**
100-GK.....Complete Gasket Kit (See Accessories Page)
- **Kits:**
100-DEPR KITDepressurizer Kit (See Accessories Page)
100-MNTG KITMounting Bracket Kit
(See Accessories Page)
- **Form 4100:**
Installation, Operation, Parts & Service Information
- **Form 4123:**
Marine Installation, Operation, Parts & Service Information

Used On

- Small Diesel Engines Up to Approx. 200 HP (Except Cummins & Detroit Diesel Engines)
- Cars, Light-Duty Trucks & RV's
- Small Pleasure Crafts & Sailboats
- Caterpillar Engines Thru 3300 Series
- Small Generators & Farm Tractors
- Refrigeration Units
- 5.7L & 6.2L GMC Engines

* Standard with Unit Unless Stated.



WARNING: These products can expose you to chemicals, including Diisononyl Phthalate, Carbon black extracts, Nickel, 1,3 Butadiene, Ethylene Oxide, Epichlorohydrin, which are known to the State of California to cause cancer, and Bisphenol-A, Ethylene Glycol, Ethylene Oxide, 1,3 Butadiene, Epichlorohydrin, which are known to the State of California to cause birth defects or other reproductive harm. For more information go to www.P65Warnings.ca.gov.

100 Series Diesel Fuel Filter/Water Separators (Cont'd.)

Accessories

All Inlet & Outlet Fittings Require O-Ring Seals

Aluminum Bowl	100-21AL
Clear Bowl w/Water Sensor Probes	100-21BP
Clear Bowl w/Heater Probes	100-21H
Clear Bowl w/Marine Collar for Marine Units	100-21M
Fittings.....	See DAHL Fittings Chart
Heat Deflector Shield for Marine Units.....	185-DS
Heater Kit...See Accessories Page (Heater Kits & Heater Parts)	
Shock Pad Mounting Kit.....	186-SK
Water Sensor Warning Light Kit (Use with 100-21BP)	
24 Volt DC	24-WLK

100 Series Single Units

100	Diesel Fuel Filter/Water Separator
100-BP	Diesel Fuel Filter/Water Separator with Water Sensor Bowl Probes — Order Warning Light Kit separately.
100-H	Diesel Fuel Filter/Water Separator with In-Filter Heater — Dash-Mounted Toggle Switch included. Operates on either 12 or 24 Volt systems. — 5 Micron Nominal (25 Absolute) Element
100-M	Marine Diesel Fuel Filter/Water Separator
100-W	Diesel Fuel Filter/Water Separator — 5 Micron Nominal (25 Absolute) Element
100-W30	Diesel Fuel Filter/Water Separator — 9 Micron Nominal (40 Absolute) Element

100 Series Double Manifold Units

- 100-MFV** Two Diesel Fuel Filter/Water Separators Manifolded with Shut-Off Valves — Allows continuous operation while servicing.
- 100-MMV** Two Marine Diesel Fuel Filter/Water Separators Manifolded with Shut-Off Valves — Allows continuous operation while servicing.

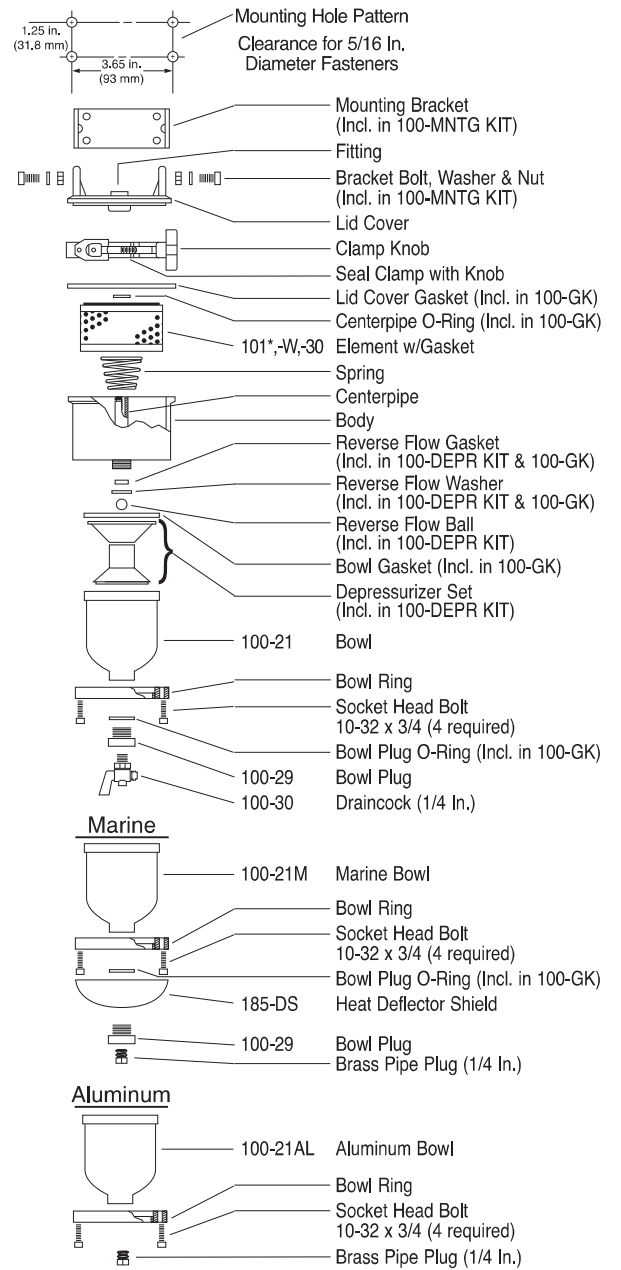

* Standard with Unit Unless Stated.



WARNING: These products can expose you to chemicals, including Diisononyl Phthalate, Carbon black extracts, Nickel, 1,3 Butadiene, Ethylene Oxide, Epichlorohydrin, which are known to the State of California to cause cancer, and Bisphenol-A, Ethylene Glycol, Ethylene Oxide, 1,3 Butadiene, Epichlorohydrin, which are known to the State of California to cause birth defects or other reproductive harm. For more information go to www.P65Warnings.ca.gov.