

200 Series Diesel Fuel Filter/Water Separators



MODEL 200
Diesel Fuel Filter/Water Separator



MODEL 200-M
Marine Diesel Fuel Filter/Water Separator



MODEL 200-MFV
Double Manifold Diesel Fuel Filter/Water Separator
with Shut-Off Valves for Continuous Operation



MODEL 200-MMV
Double Marine Manifold Diesel Fuel Filter/Water Separator
with Shut-Off Valves for Continuous Operation

Specifications

- **Flow Resistance:**1.0 In. Mercury
- **Maximum Working Pressure:**.....25 PSI (172 kPa)
- **Temperature Range:**-50° to +225°F (-45° to +107°C)
- **Port Thread:**
Single Units:7/8-14 w/O-Ring Boss
Double Units:.....3/4-14 NPT
- **Height:**.....16 3/4 In. (425.5 mm)
- **Width:**7 1/2 In. (190.5 mm)
- **Depth:**.....7 3/4 In. (196.9 mm)
- **Element Removal Clearance:**.....2 1/2 In. (63.5 mm)
- **Sump Capacity:**24 oz. (708 ml)
- **Top to Inlet Clearance:**2 5/8 In. (66.7 mm)
- **Top to Outlet Clearance:**2 5/8 In. (66.7 mm)

Flow Rates

- **Single Model 200 Series:**
Recommended:.....120 GPH (U.S.) (454 LPH)
Maximum:200 GPH (U.S.) (757 LPH)
- **Double Model 200 Series:**
Recommended:.....240 GPH (U.S.) (908 LPH)
Maximum:400 GPH (U.S.) (1,514 LPH)

Service Parts

- **Elements:**
201*4 Micron Nominal (20 Absolute) Element
201-W.....5 Micron Nominal (25 Absolute) Element
201-30.....9 Micron Nominal (40 Absolute) Element
- **Gaskets:**
200-GK.....Complete Gasket Kit (See Accessories Page)
- **Kits:**
200-DEPR KIT.....Depressurizer Kit (See Accessories Page)
- **Form 4230:**
Installation, Operation, Parts & Service Information
- **Form 4123:**
Marine Installation, Operation, Parts & Service Information

* Standard with Unit Unless Stated.



WARNING: These products can expose you to chemicals, including Diisononyl Phthalate, Carbon black extracts, Nickel, 1,3 Butadiene, Ethylene Oxide, Epichlorohydrin, which are known to the State of California to cause cancer, and Bisphenol-A, Ethylene Glycol, Ethylene Oxide, 1,3 Butadiene, Epichlorohydrin, which are known to the State of California to cause birth defects or other reproductive harm. For more information go to www.P65Warnings.ca.gov.

200 Series Diesel Fuel Filter/Water Separators (Cont'd.)

Accessories

All Inlet & Outlet Fittings Require O-Ring Seals

Aluminum Bowl	200-21AL
Clear Bowl w/Water Sensor Probes	200-21BP
Clear Bowl w/Heater Probes	200-21H
Clear Bowl w/Water Sensor & Heater Probes	200-21HBP
Clear Bowl w/Marine Collar for Marine Units	200-21M
Fittings.....	See DAHL Fittings Chart
Heat Deflector Shield for Marine Units.....	285-DS
Heater Kit...See Accessories Page (Heater Kits & Heater Parts)	
Shock Pad Mounting Kit	286-SK
Water Sensor Warning Light Kit (Use with 200-21BP)	
24 Volt DC	24-WLK

200 Series Single Units

200	Diesel Fuel Filter/Water Separator
200-H	Diesel Fuel Filter/Water Separator with In-Filter Heater — Operates on either 12 or 24 Volt systems — 5 Micron Nominal (25 Absolute) Element
200-M	Marine Diesel Fuel Filter/Water Separator
200-W30	Diesel Fuel Filter/Water Separator — 9 Micron Nominal (40 Absolute) Element

200 Series Double Manifold Units

200-MFV	Two Diesel Fuel Filter/Water Separators Manifolded with Shut-Off Valves — Allows continuous operation while servicing.
200-MMV	Two Marine Diesel Fuel Filter/Water Separators Manifolded with Shut-Off Valves — Allows continuous operation while servicing.

Used On

- 8 Cylinder Cummins & Detroit Diesel Engines
- Caterpillar Engines up to Approximately 1,000 HP (Including 399)
- Most Other Medium Size Diesel Engines up to Approximately 1,000 HP
- Trucks & Buses
- Construction & Farm Equipment
- Medium Size Generators
- Smaller Commercial Boats

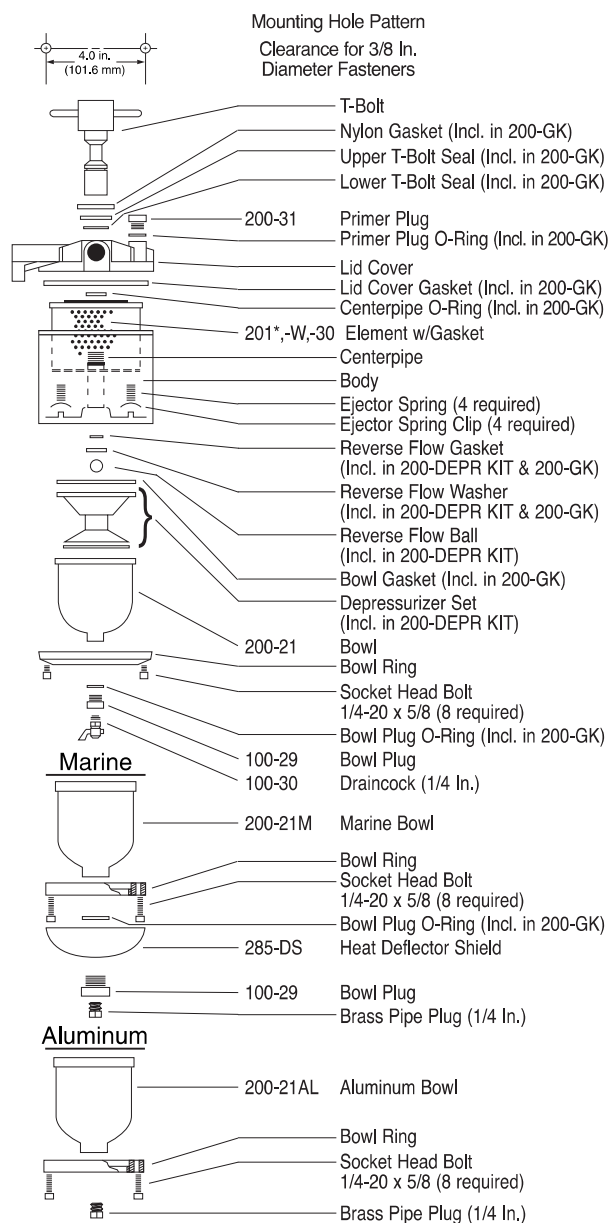

* Standard with Unit Unless Stated.



WARNING: These products can expose you to chemicals, including Diisononyl Phthalate, Carbon black extracts, Nickel, 1,3 Butadiene, Ethylene Oxide, Epichlorohydrin, which are known to the State of California to cause cancer, and Bisphenol-A, Ethylene Glycol, Ethylene Oxide, 1,3 Butadiene, Epichlorohydrin, which are known to the State of California to cause birth defects or other reproductive harm. For more information go to www.P65Warnings.ca.gov.