

Union Elbow SL

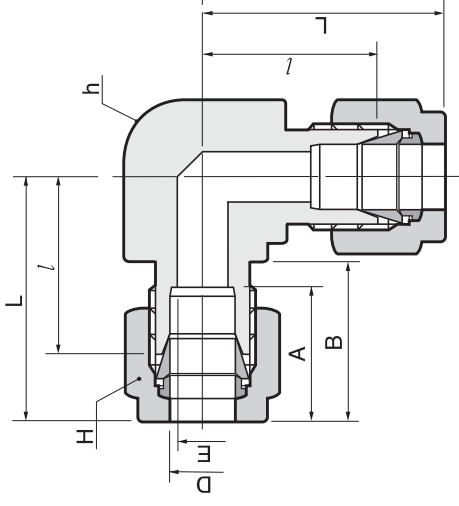

Connects fractional tube

Part No.	Tube O.D. D		E Min.	Width across flat				L	
	in	mm		h		H			
SL-1	1/16	1.59	1.27	3/8	9.52	5/16	7.93	14.00	17.88
SL-2	1/8	3.17	2.28	3/8	9.52	7/16	11.11	15.74	22.35
SL-3	3/16	4.76	3.04	1/2	12.70	1/2	12.70	17.78	24.38
SL-4	1/4	6.35	4.82	1/2	12.70	9/16	14.28	19.55	26.92
SL-5	5/16	7.93	6.35	9/16	14.28	5/8	15.87	21.33	28.70
SL-6	3/8	9.52	7.11	5/8	15.87	11/16	17.46	23.11	30.48
SL-8	1/2	12.70	10.41	13/16	20.64	7/8	22.22	25.90	36.06
SL-10	5/8	15.87	12.70	15/16	23.81	1	25.40	28.70	38.80
SL-12	3/4	19.05	15.74	1-1/16	26.98	1-1/8	28.58	29.71	39.87
SL-14	7/8	22.22	18.28	1-1/4	31.75	1-1/4	31.75	34.54	44.70
SL-16	1	25.40	22.35	1-3/8	34.9	1-1/2	38.10	36.83	49.02
SL-20	1-1/4	31.75	27.68	1-11/16	42.86	1-7/8	47.63	44.50	66.54
SL-24	1-1/2	38.10	34.03	2	50.80	2-1/4	57.15	50.80	77.97
SL-32	2	50.80	45.97	2-3/4	69.85	3	76.20	62.73	107.18